

Base Pan Heater Installation Manual

Required tools for Installation Works

1 Phillips screw driver	3 Cutter	5 Multimeter
2 Glove	4 Plier	

SAFETY PRECAUTIONS

- Read the following "SAFETY PRECAUTIONS" carefully before installation.
- Electrical work must be installed by a licensed electrician.
- The caution items stated here must be followed because these important contents are related to safety. The meaning of each indication used is as below. Incorrect installation due to ignoring of the instruction will cause harm or damage, and the seriousness is classified by the following indications.

	WARNING	This indication shows the possibility of causing death or serious injury.
	CAUTION	This indication shows the possibility of causing injury or damage to properties only.

The items to be followed are classified by the symbols:

	Symbol with white background denotes item that is PROHIBITED from doing.
	Symbol with dark background denotes item that must be carried out.

- Carry out test run to confirm that no abnormality occurs after the installation. Then, explain to user the operation, care and maintenance as stated in instructions. Please remind the customer to keep the operating instructions for future reference.

WARNING

- Be sure to disconnect all power supply before install and connect the Base Pan Heater. Otherwise, it will cause the electrical shock.
- Engage authorized dealer or specialist for installation. If installation done by the user is defective, it will cause electrical shock or fire.
- Install the Base Pan Heater strictly according to this installation instruction to prevent electrical shock or fire.
- Use only the attached accessory parts for installation to prevent electrical shock or fire.
- For electrical work, follow the local wiring standard, regulation and this installation instruction. Otherwise, it will cause the electrical shock or fire.
- The Base Pan Heater must be routed and installed properly to prevent the damage of outdoor unit or electrical shock or fire.
- Do not modify the length of the Base Pan Heater lead wires. Otherwise, it will cause abnormal operations, fire or electrical shocks.
- Wear protective glove and use proper tools for installation work to prevent injury from metal parts or sharp edges.
- Do not touch the heating cable side when the Base Pan Heater is activated. Otherwise, it will cause injury due to high temperature of the heating cable side surface.

Attached Accessory

No.	Accessory Part	Qty.	No.	Accessory Part	Qty.
1	Base Pan Heater	1	3	Adjustable cable tie	1
2	Band	16	4	Cable Tie	1

Base Pan Heater Specification

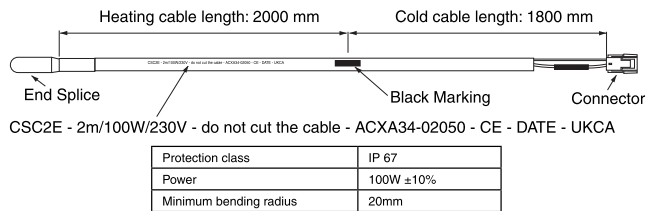

How to Install Base Pan Heater to Outdoor Unit (WH-WDG05LE5, WH-WDG07LE5, WH-WDG09LE5)

Before installing the Base Pan Heater, steps below need to be carried out to remove the exterior chassis.

WARNING

Be sure to switch off all power supply (i.e. indoor power supply, heater power supply, Tank Unit power supply) before performing the steps below to avoid electrical shock, etc.

STEP 1: Removal of the Outdoor Unit Cabinet Plate

- To remove both left and right discharge grilles, unscrew the 7 screws. (Fig. 1a)
- To remove the Right Cabinet Front Plate and Cabinet Top Plate, unscrew the 12 screws. (Fig. 1b)
- To remove the Left Cabinet Front Plate, unscrew the 10 screws. (Fig. 1c)

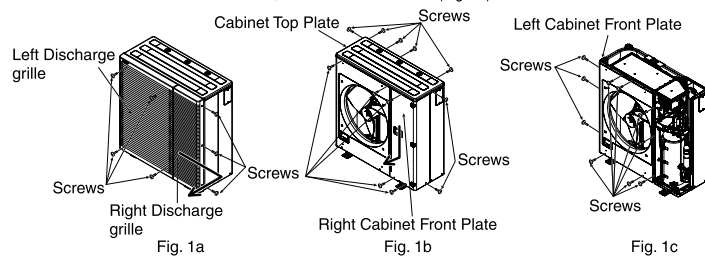

STEP 2: Installation Work: Guide Base Pan Heater (cold cable side)

- Connect the connector from base pan heater to the white connector from the PCB. (Fig. 2a)
- Insert the heating cable side through the bushing on the sound proof board. (Fig. 2b)

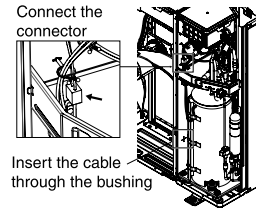

Fig. 2a

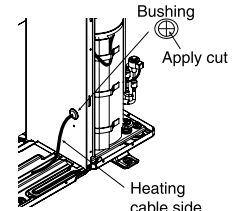

Fig. 2b

STEP 3: Installation Work: Guide Base Pan Heater (heating cable side)

- Check and identify the heating cable side from the end splice to black marking. (Refer to base pan heater specification)
- Begin guiding the heating cable from the end splice as shown in Fig. 3a. Fix the cable with band 2 at 16 locations. Make sure the heater is installed as close as possible to the condenser and the water discharge holes. (Fig. 3a, 3b and 3c)
- During Base Pan Heater installation, ensure the entire fixed heating cable side has a contact with the base pan surface.

*Note: - Removing the Propeller Fan is not recommended during this installation work. However, if it was removed, be sure to retighten the nut with 490.3 to 686.5 cN/m.

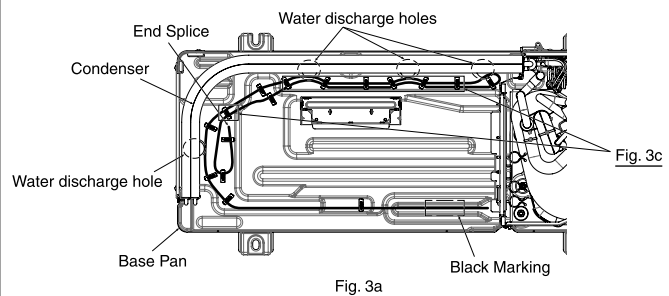

Fig. 3a

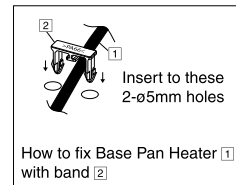

Fig. 3b
(9 locations)

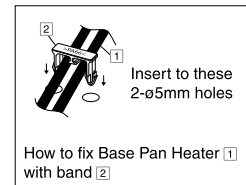
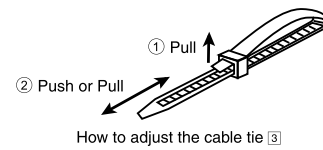

Fig. 3c
(7 locations)

STEP 4: Installation Work: Guide Base Pan Heater (tidy up the cable)

- Attach the adjustable cable tie 3 to the sound proof board. (Fig. 4a)
- Fix the cable to sound proof board with adjustable cable tie 3. (Fig. 4a)



- Bundle the extra cable in the machine room side with cable tie 4, and put it between the compressor and the sound proof board. (Fig. 4b)

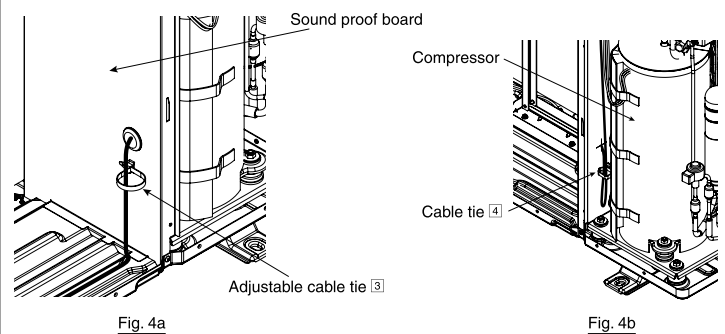

STEP 5: Activate The Base Pan Heater Control Using Touch Panel Remote Controller

Refer to the Indoor Unit/Tank Unit installation manual (system installation) for Base Pan Heater activation.